

FRATELLI
gruppi mobili



FRATELLI
gruppomobili

ECONOMIC

DOORS

Albanian



ERZENI&Fratelli gruppomobili

Dyert e brendshme dhe dhomat e gjumit qe prodhon Kompania ERZENI&Fratelli Gruppomobili, perbejne prodhimet baze te kompanise, qe realizohen fale nje pune dhe eksperience 20 vjecare, punonjesve te kualifikuar, zbatimit te teknologjive me moderne dhe investimeve te kryera ne linjat teknologjike me makineri te standarteve me te larta.

Shkodra, qyteti ku lindi dhe u zhvillua ERZENI&Fratelli Gruppomobili, eshte qyteti ku projektohen dhe realizohen prodhimet tona, ne ambientet prodhuese dhe ndihmese ne nje territor qe ze 19250 m2, ku jane te angazhuar 130 punonjes te kualifikuar dhe staf inxhiniero menaxherial.

ERZENI&Fratelli Gruppomobili, sheh e projekton te ardhmen e tij ne plotesim maksimal te kerkesave, shijeve, modeleve klasike e moderne te produkteve, perdorimin efikas dhe prioritar te lendeve te para dhe aksesoreve sa me cilesor.

Motoja e punes se ERZENI&Fratelli Gruppomobili eshte cmim dhe cilesi, me synim ekonomizimin maksimal te investimit te klientit.

ERZENI&Fratelli Gruppomobili eshte nder kompanite e para zoteruese e certifikatave me presigjoze nderkombetare te cilesise dhe menaxhimit ambientet ISO 9001 - 2008 dhe ISO 14001 - 2004

ERZENI&Fratelli Gruppomobili dhe stafi i saj, ecen me synimin e lidershit rajonal te kompanive prodhuese te furniturave me baze druri.

Ne ERZENI&Fratelli Gruppomobili gjeni zgjidhje per cdo nevojte tuajen.

ITALIANO



La ditta Erzeni & Fratelli Gruppomobili

Le porte interne ed i mobili per camere da letto prodotti dalla ditta Erzeni & Fratelli Gruppomobili compongono i prodotti principali della stessa, che vengono realizzati e fabbricati grazie ad un lavoro ed esperienza di oltre 20 anni, personale ben- qualificata, applicazione delle tecnologie modernissime ed investimenti effettuati nelle linee tecnologiche con macchine di standard elevatissimo.

Scutari, la città dove è fondata e cresciuta la ditta Erzeni & Fratelli Gruppomobili, è la città dove vengono disegnati e fabbricati nostri prodotti, nelle fattorie di produzione e quelle ausiliarie che occupano un territorio di 19250 mq circa, dove sono impegnati 130 lavoratori qualificati e lo staff ingegnere - manageriale.

La ditta Erzeni & Fratelli Gruppomobili vede se stessa proiettando suo futuro nell'adempimento a livello massimo delle richieste e gusti dei clienti, presentazione di nuovi modelli classici e moderni, efficace e prioritario utilizzo di materia prima, e accessori di ottima qualità.

Il motto del lavoro della ditta Erzeni & Fratelli Gruppomobili è di offrire buoni prezzi ad ottima qualità, al fine di massima economizzare dell'investimento del cliente.

La ditta Erzeni & Fratelli Gruppomobili è una tra le prime ditte in possesso di certificate internazionali di qualità e gestione ambientale ISO 9001-2008 e ISO 14001-2004.

La ditta Erzeni & Fratelli Gruppomobili e suo staff avanza allo scopo di leadership regionale delle ditte produttrici degli arredi da lego.

Alla ditta Erzeni & Fratelli Gruppomobili voi troverete soluzioni di ogni vostra esigenza.

ENGLISH



Erzeni & Fratelli Gruppomobili

Since the foundation of our company in 1998, we have used the more advanced technologies in order to offer our clients quality products .The company located in two centers, Albania and Turkey uses a production space of 20 000 m2, from which 15000 closed area and 5000 open area.

In these 17 years, by being part of many private projects and TOKI EMLAK KONUT projects, the company has become one of the leader companies in the sector of door production.

Using reserves of trees and qualitative, economic panels of Balkans the door production begins in Albania with production of semi finished frames, moldings and door mdf panels and finishes in Turkey with production of the complete product : door.

Our market is led by Turkish market, but we also make exports to many countries in Asia, Africa, Middle East and the Balkans.

The company known as" Fratelli" in the world market and "Arem" in the Turkish market has a staff of 135 employees.

The company well known for internal doors covered by PVC materials, STRLAM, MELAMIN, LAMINATE, launched this year also the sale of frames and moldings and mdf panel leaves of 4mm, 6mm, 8mm covered by these materials.

Our goal is to be a successful firm, long-lived and accepted in world markets.

STR LAM



Modern Tik Horizontal



Meshe Gobek



Ipek Zejtin Gobek



Bambu Gobek



Alpi Beyaz Gobek



Vario Gevis horizontal

FRATELLI

gruppomobili

PVC Ozigo



PVC Walnut



PVC Pana



PVC Rover



PVC Coco



PVC Cherry



PVC Wenge



PVC Tik



PVC Bambu



KAPAK



KASA

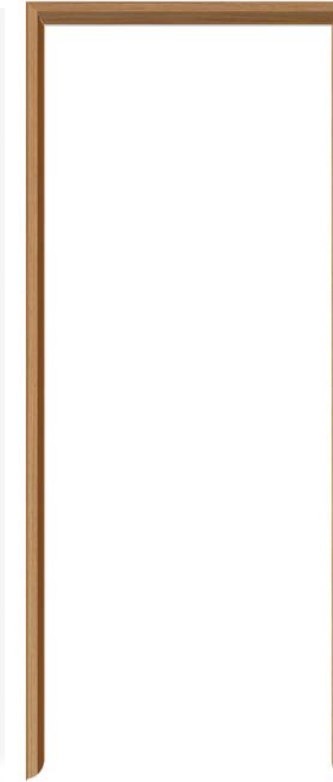

FASHATURA

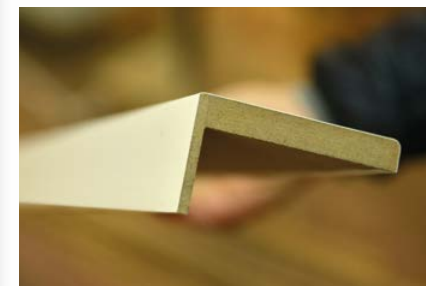
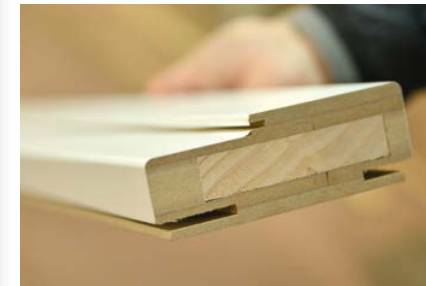
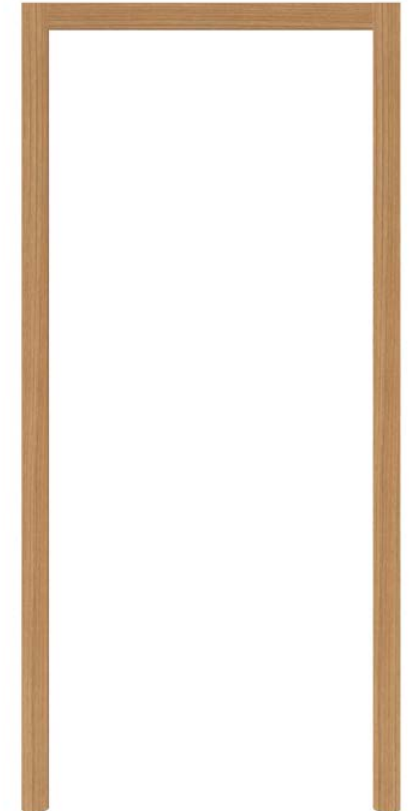

FRATELLI

gruppo mobili

QMSCERT CERTIFIKATE

QMSCERT, an accredited provider of third-party system certification organization for ISO 14001 environmental management systems and acting in accordance with the requirements of ISO 17021 for registrars attests that:

ERZENI SH.P.K
SHKODER, 4001
ALBANIA

with a scope of:

Design, Production, Installation & Trade of Home, Office, School Furniture & Inside & Armoured Doors

has established an environmental management system that is in conformance with the International Standard

EN ISO 14001:2004

April 19th, 2015
Certification Period Ending

April 20th, 2012
Certification Date

NACE Code: 31

For the QMSCERT Board

CERT Inspection - Certification

IAF INTERNATIONAL ACCREDITED FORUM

ESYD EUROPEAN SYSTEMS FOR YOUNG DESIGNERS

QMSCERT® N. 140412/3348

MS Certification Cert. No. 110-2

QMSCERT 26th OCTOBER Str. 90 - GR 546 27 - THESSALONIKI - HELLAS

QMSCERT CERTIFIKATE

QMSCERT, an accredited provider of third-party system certification organization for ISO 9001 quality management systems and acting in accordance with the requirements of ISO 17021 for registrars attests that:

ERZENI SH.P.K
SHKODER, 4001
ALBANIA

with a scope of:

Design, Production, Installation & Trade of Home, Office, School Furniture & Inside & Armoured Doors

has established a quality management system that is in conformance with the International Standard

EN ISO 9001:2008

April 19th, 2015
Certification Period Ending

April 20th, 2012
Certification Date

IAF/EA Subsector: 23

For the QMSCERT Board

CERT Inspection - Certification

IAF INTERNATIONAL ACCREDITED FORUM

ESYD EUROPEAN SYSTEMS FOR YOUNG DESIGNERS

QMSCERT® N. 140412/3347

MS Certification Cert. No. 110-2

QMSCERT 26th OCTOBER Str. 90 - GR 546 27 - THESSALONIKI - HELLAS





FRATELLI

gruppomobili

"Construction Door Elements System"

Fratelli Gruppomobili

DOOR Description Kapak

Height Cutting Tolerance : "42mm." on the part of cutting Top/Bottom
 FGM Door Length : 2090mm-2010mm
 FGM Door Material Thickness : 42mm.
 FGM Door KEY Place Operation : ITS A FINISHED !!!
 Surface Core Materials : M D F within NOT Ure Formaldehit
 FGM Door Technical Surface : Its a manufacture Flat Lamination with 110 cm width which provides a wrapping of surface and edges without interruption. This guarantees the quality of edge wrapping and doesnt lead to unsticking or ripping off the edges even in high temperature

Flat Lamination Adhesive : Termosetting Chemical QUBAN-Polyurethane
 General Press Adhesive : D-3 Class
 Lamination Covering Material : Decorative Double Layer P V C Sheet
 FGM Door Decorative Patterns : Wood DESIGN "Exclusive Fratelli Gruppomobili's"
 FGM Door Patterns Definition : Right & Left Vertical wood design., Article intermediate Horizontal wood design.,

FGM Door Wood Construction : Within %6 between %9 Ladin-wood
 FingerJoint Wood Thickness è 50mm. X 35mm.
 + (Lamination Pressing)
 Edge Core M D F Thickness è 4mm. X 35mm.

FGM Door 's Filling Material : Craft Paper Honeycomb

Fratelli Gruppomobili DOORS Size Kapak

** FGM Door S i z e : 725mm.(W) x 2090mm.(L) x 42mm.(T)
 ** FGM Door S i z e : 825mm.(W) x 2090mm.(L) x 42mm.(T)
 ** FGM Door S i z e : 925mm.(W) x 2090mm.(L) x 42mm.(T)
 ** FGM Door S i z e : 455mm. x 2090mm. x 42mm. è (Support Width)

FGM

FRAME Description Kasa

Height Cutting Tolerance : On the part of cutting Top/Bottom
 FGM Frame Length : 2100mm.
 FGM Frame Material Thickness : 42mm.
 Core Materials : M D F within NOT Ure Formaldehit
 FGM Frame Technical Surface : Its a manufacture "Wrapping Discipline"
 Also, (2.7mm.MDF +16mm.MDF +2.7mm.MDF +16mm.Ladin FingerJoint wood + 2.7mm.MDF)

FGM Frame Fuse Material : 45 Shor // Co-extruder NITRILE Chemicals Material
 Wrapping Lamination Adhesive : Termosetting Chemical QUBAN-Polyurethane
 General Press Adhesive : D-3 Class
 Lamination Covering Material : Decorative Double Layer P V C Sheet
 FGM Frame Decorative Patterns : Wood DESIGN " Exclusive FGM's "
 FGM Frame Patterns Definition : Only Vertical wood design.,

FGM

CORNICE Moulding Description

Height Cutting Tolerance : On the part of cutting Top/Bottom
 FGM Moulding Length : 2200mm.
 FGM Moulding Thickness : 67mm. x 12mm/Thick. + 40mm.(Skirt-4mm.)
 FGM Moulding Position Radius : 80mm. (Large Tangent)
 FGM Moulding Economic Thickness : 67mm. x 8mm/Thick. + 40mm.(Skirt-4mm.)
 FGM Moulding Position Radius : Flat surface (Classic)
 Core Materials : M D F within NOT Ure Formaldehit
 Wrapping Lamination Adhesive : Termosetting Chemical QUBAN-Polyurethane
 General Edge Press Adhesive : Hotmelt – HENKEL GmbH.
 Lamination Covering Material : Decorative Double Layer P V C Sheet
 FGM Moulding Decorative Patterns : Wood DESIGN " Exclusive FGM's "
 FGM Moulding Patterns Definition : Only Vertical wood design.,

Fratelli Gruppomobili "Construction Door Elements System" Technical Page Cross Section

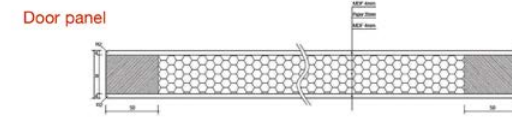

For Door Frame

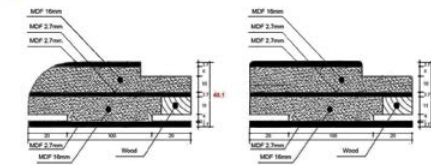

For Door Cornice Molding

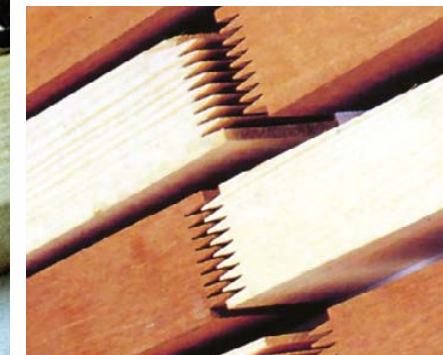



DYER TË VESHURA ME **PVC**
PVC VENEERED

COD PVC
Rover
HV
016





COD PVC
Ozigo
Horizontal
015

FRATELLI
gruppomobili



COD PVC
Bambu
HV
017





COD PVC
Walnut
Glass
018

FRATELLI
gruppomobili



COD PVC
Walnut
HV
019





COD PVC
Coco
HV
020

FRATELLI
gruppomobili



COD PVC
Coco
Glass
021





COD PVC
Rover
022

FRATELLI
gruppomobili



COD PVC
Walnut
023





COD PVC
Pana
024

FRATELLI
gruppomobili



COD PVC
Cherry
025



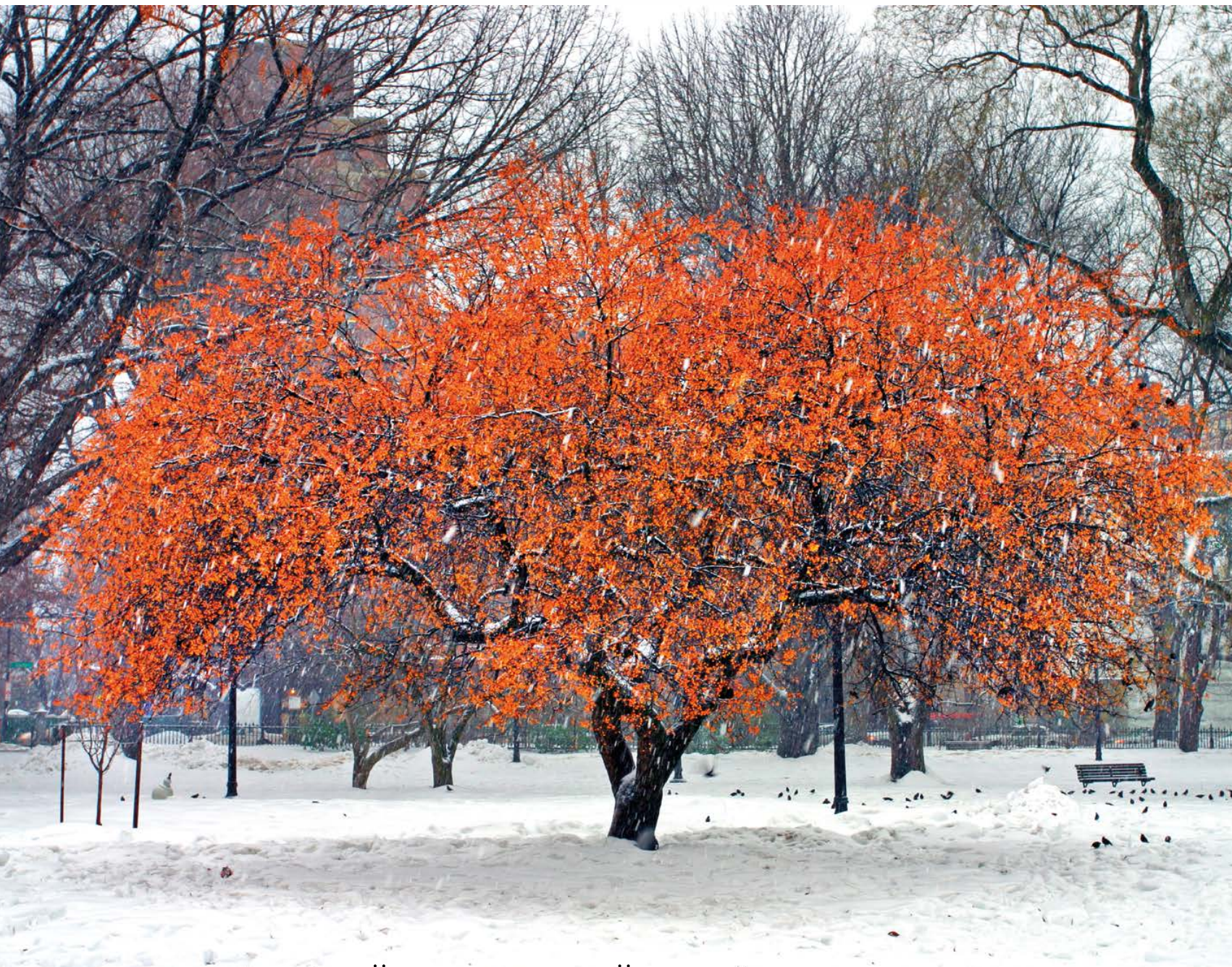

DYER TË BARDHA TË VESHURA ME **PVC**
PVC WHITE DOORS

COD PVC
White
SRL 001





COD PVC
White
SRL 002

FRATELLI
gruppomobili



COD PVC
White
SRL 003





COD PVC
White
SRL 004

FRATELLI
gruppomobili



COD PVC
White
SRL 005

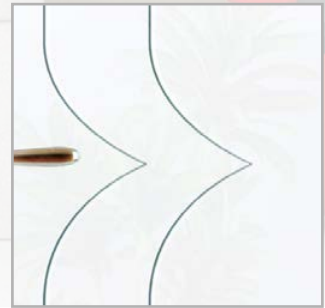



COD PVC
White
SRL 006

FRATELLI
gruppomobili



COD PVC
White & Tik
SRL 007





COD PVC
White
Swarovski
SRL 008

FRATELLI
gruppomobili

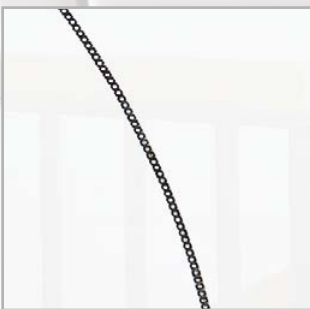

COD PVC
White
Swarovski
SRL 009



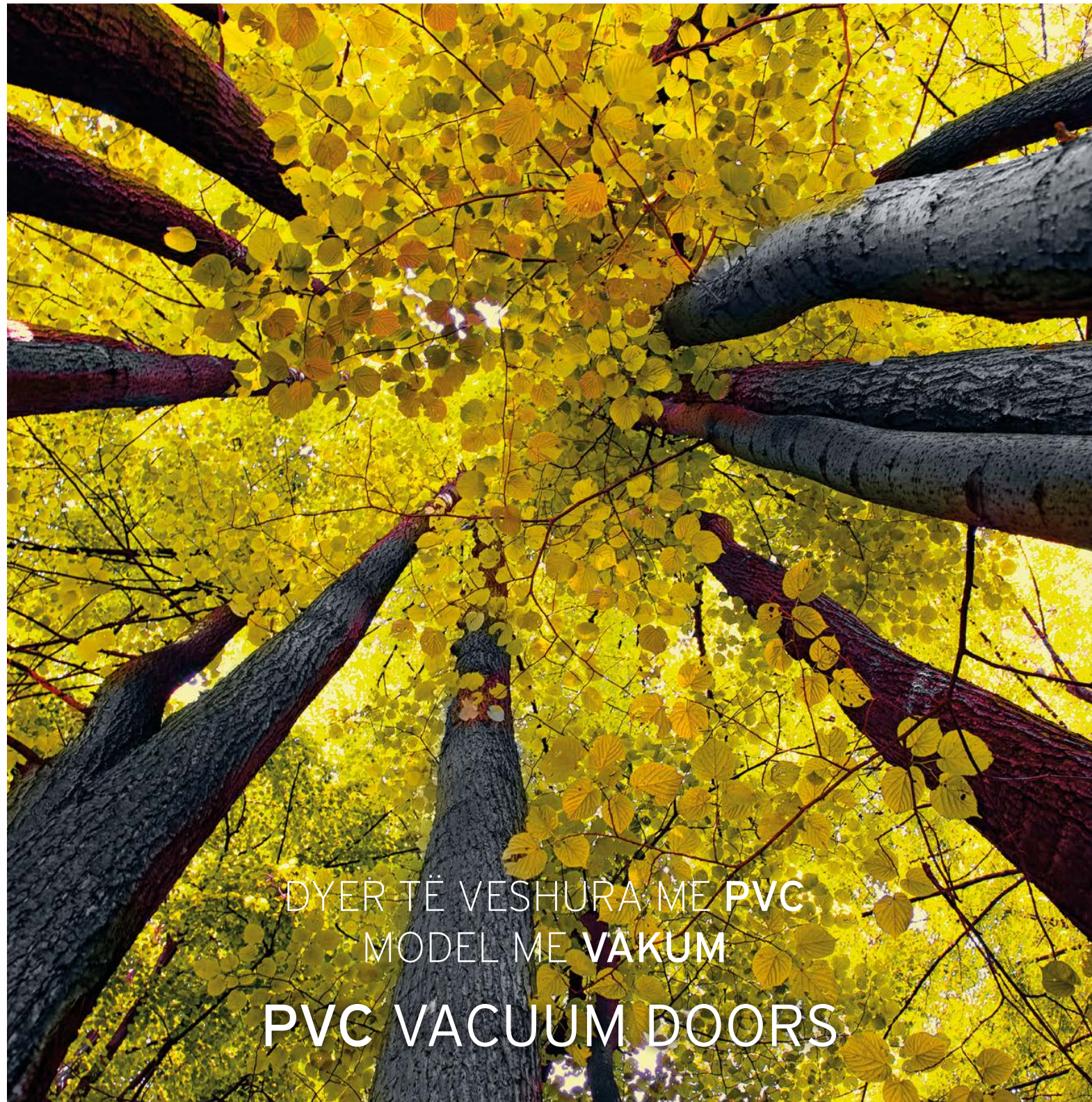

COD PVC
Tik
SRL
026





COD PVC
Wenge & Alumin
SRL
027



FRATELLI
gruppomobili



COD PVC
Walnut
SRL
028





COD PVC
Wenge
SRL
029

FRATELLI
gruppomobili

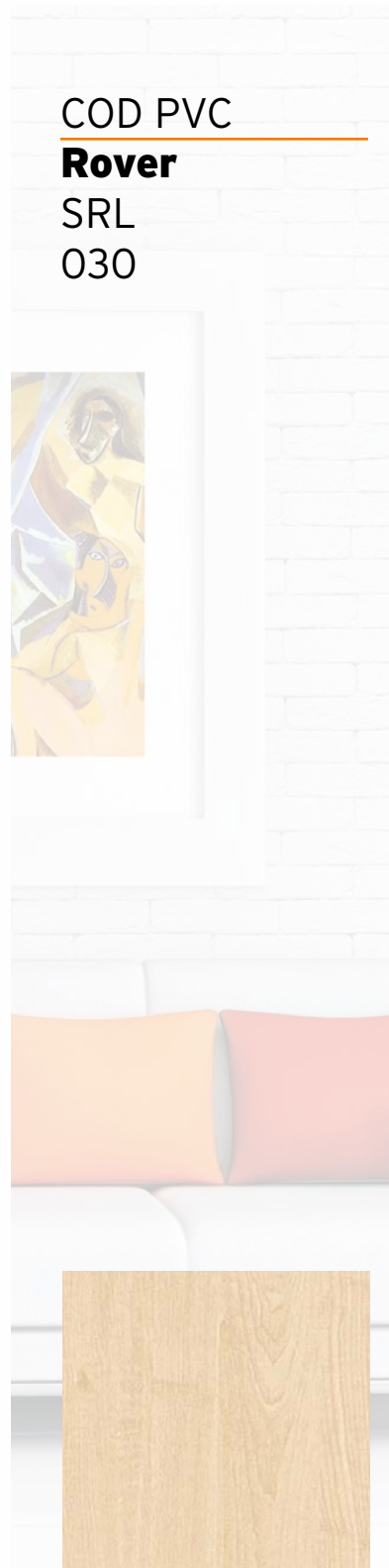

COD PVC
Rover
SRL
030



COD PVC
Cherry
SRL
031

COD PVC
Cherry
SRL
032

FRATELLI
gruppomobili



COD PVC
Walnut
SRL
033



FRATELLI
gruppomobili



COD PVC
White
SRL
034



DYER TË VESHURA ME STR LAM

STR LAM

COD
STR Lam
Ipek Zejtin
HV
STRL 220





COD
STR Lam
Vario Gevis
horizontal
STRL 221

FRATELLI
gruppomobili



COD
STR Lam
Bambu Gobek
HV
STRL 222





COD
STR Lam
Modern Tik
horizontal
STRL 223

FRATELLI
gruppomobili

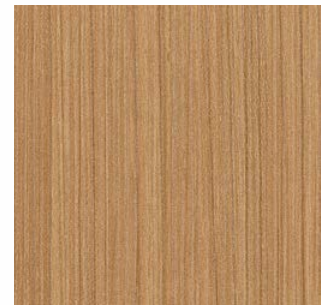

COD
STR Lam
Alpi Beas
HV
STRL 224





COD
STR Lam
Meshe Gobek
HV
STRL 225

FRATELLI
gruppomobili



COD
STR Lam
Meshe Gobek
Glass
STRL 226





DYER TË VESHURA ME **RIMESO**
WOOD VENEERED

COD
Wood
HV
035





COD
Wood
036

FRATELLI
gruppomobili



COD
Wood
SRL 037





COD
Wood
038

FRATELLI
gruppomobili

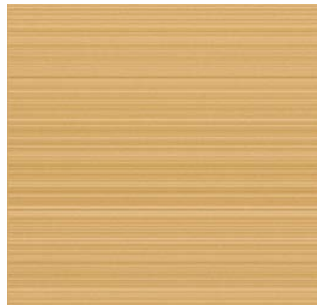

COD
Wood
SRL 039

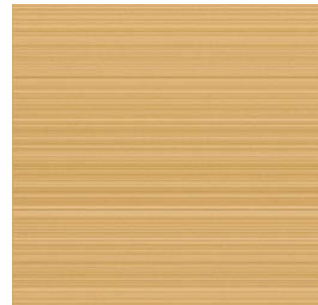



COD
Wood
040

FRATELLI
gruppomobili



COD
Wood
SRL 041

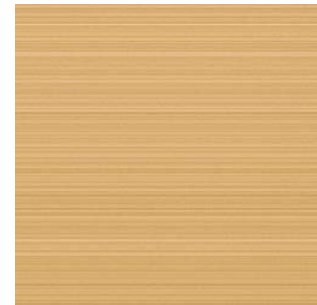

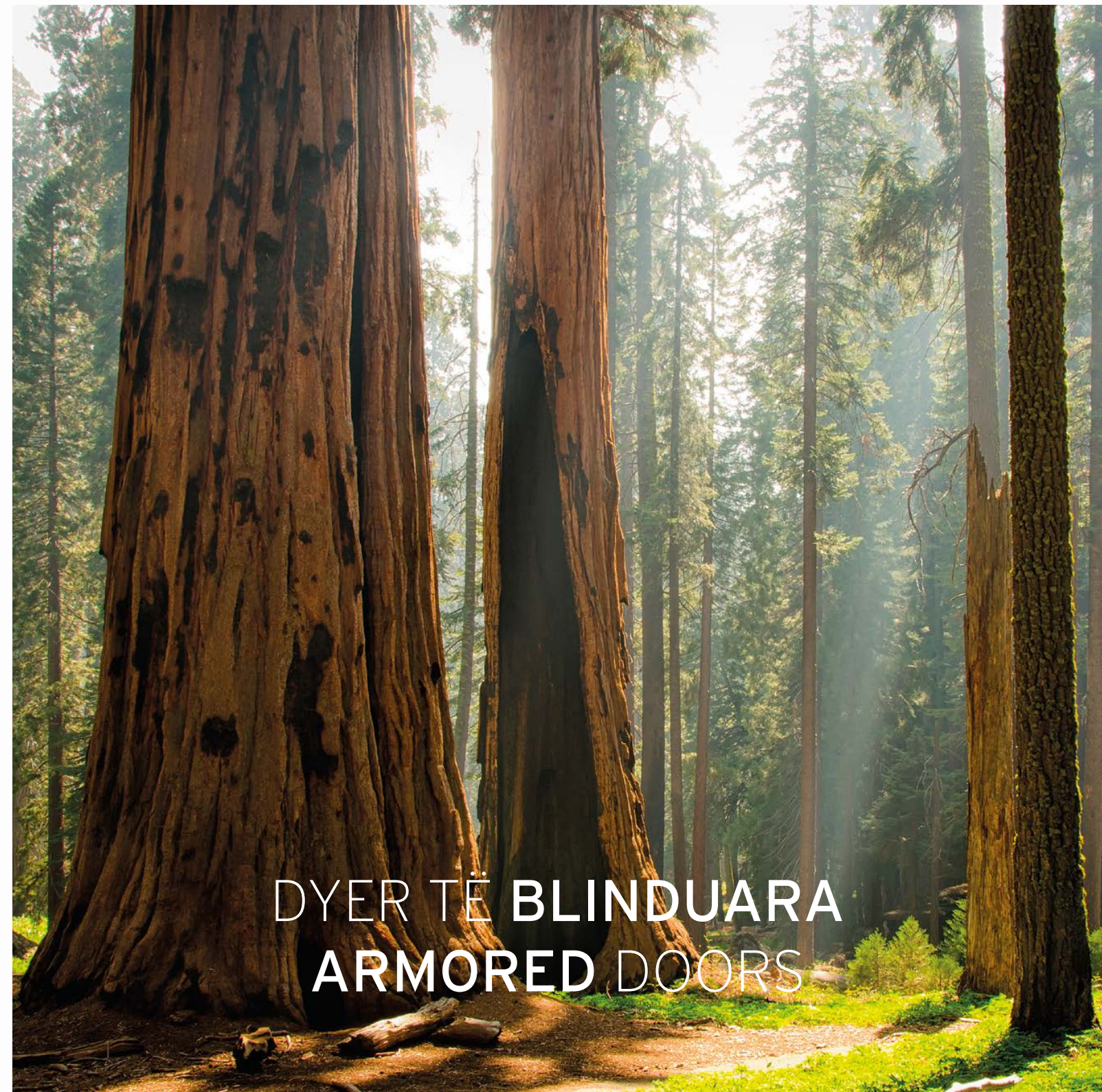

COD
Rover
HV 043





COD
Walnut
HV 044

FRATELLI
gruppomobili

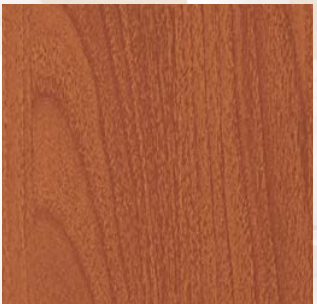

COD
Cherry
HV 045

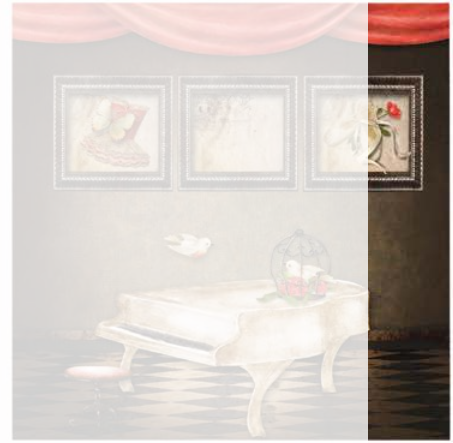

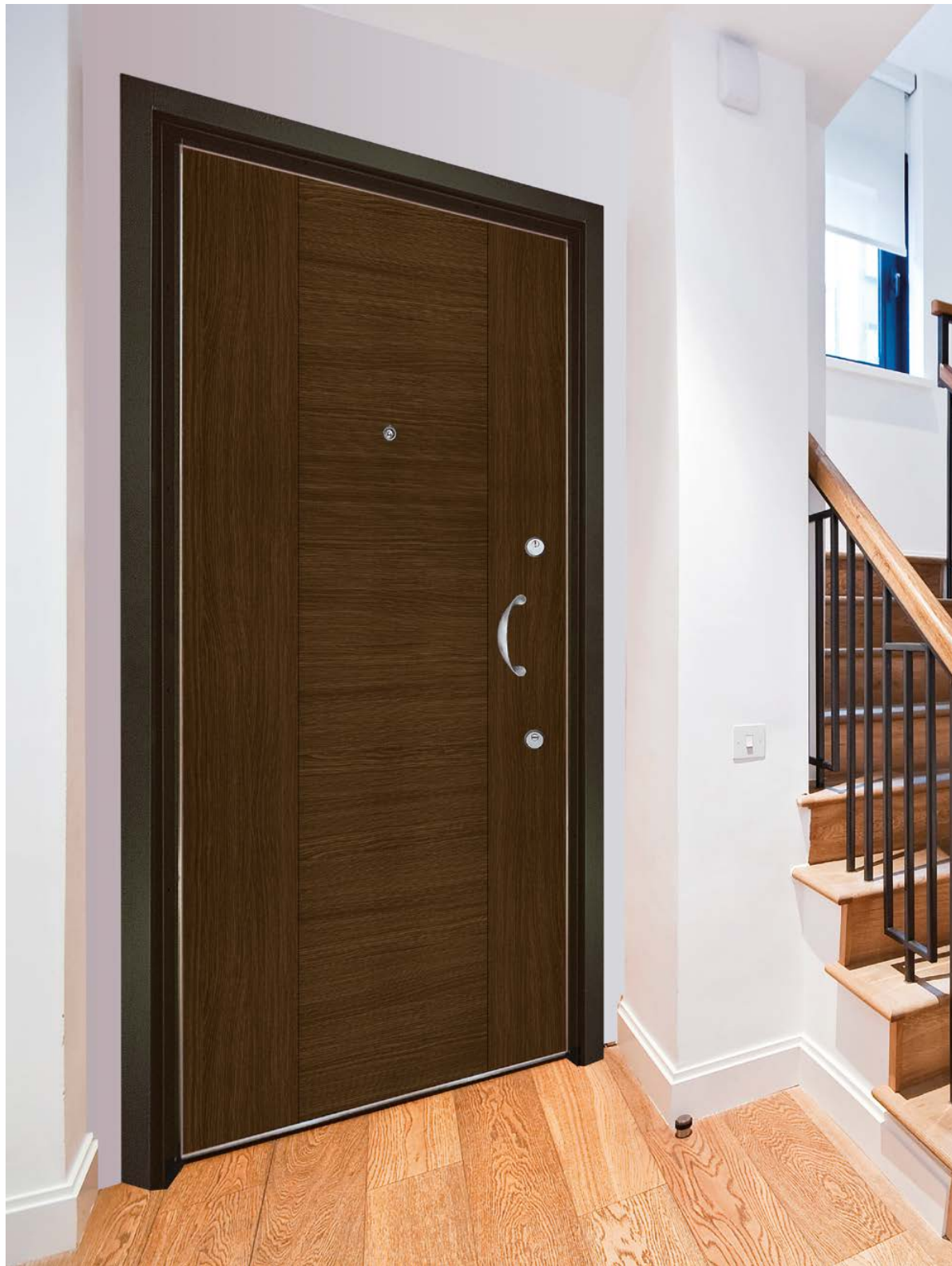

COD
Wenge
HV 042

FRATELLI
gruppomobili



COD PVC
White
SRL 046





COD PVC
White
SRL 047

FRATELLI
gruppomobili



COD PVC
White
SRL 048



FRATELLI
grupposmobili

Production: "Erzeni & Fratelligruppomobili"

Shkodër-Albania

Mob: +355 68 40 00 205

Mob: +355 68 20 22 277

Mob: +355 68 20 26 498

Mob: +355 68 40 70 391

Web: www.fratelligm.com

E-Mail: erzeni@fratelligm.com

E-Mail: erzeni7@yahoo.com